

TO REPLACE DRIVE RING

- 1) Remove splash pan.
- 2) Release upper case and place it upside down as fig. A shows.
- 3) Clean groove of ring holder with rags.
- 4) Insert new drive ring into the groove.
- 5) Push the drive ring into the groove till the last bent is snugly fitted into the groove, holding the part, arrow indicate.

Note: As fig. B shows, the angle of the groove and the ring is different, bend the drive ring slightly toward the arrow, and push it in.

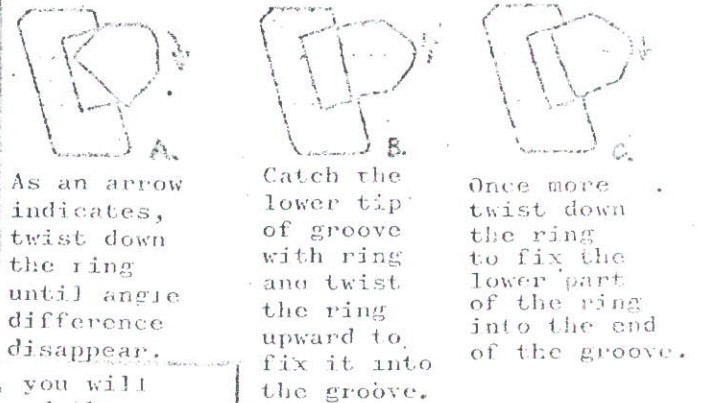
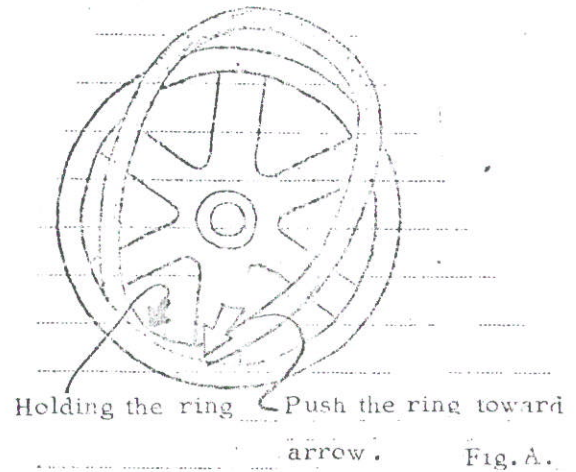

As an arrow indicates, twist down the ring until angle difference disappear.

Catch the lower tip of groove with ring and twist the ring upward to fix it into the groove.

Once more twist down the ring to fix the lower part of the ring into the end of the groove.

IMPORTANT

When you first apply ring into the groove, you will see the angle difference between the ring and the groove. To adjust the angle and snugly fix the ring into the groove, follow these procedures with care.

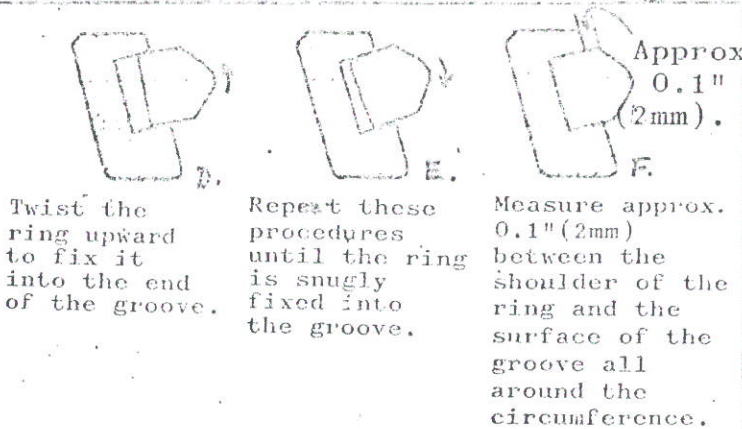

Twist the ring upward to fix it into the end of the groove.

Repeat these procedures until the ring is snugly fixed into the groove.

Measure approx. 0.1" (2mm) between the shoulder of the ring and the surface of the groove all around the circumference.

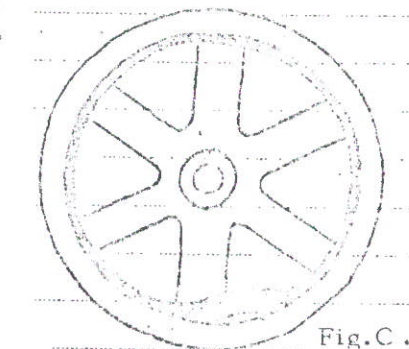

To push the last bent into the groove, follow the above procedures: A - F

- 6) Clean the drive ring with no lead, regular gasoline.
- 7) Place the upper case as the speed indicate plate and lever are in the same vertical line. Fig. D.
- 8) Screw in 4-plus pan-head screws to fasten the cases.
- 9) Operate the wheel for about 5 minutes until the ring snugly fitted into the groove and the rattling sound and vibration disappear.

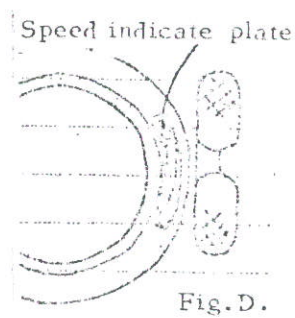

-DRIVE RING REPLACEMENT IS OVER.-

TO LOWER CONTACTING PRESSURE

1

The new drive ring increases the contacting pressure between the drive ring and the drive cone. Please adjust for longer life and more smooth pedal/lever control as follows:

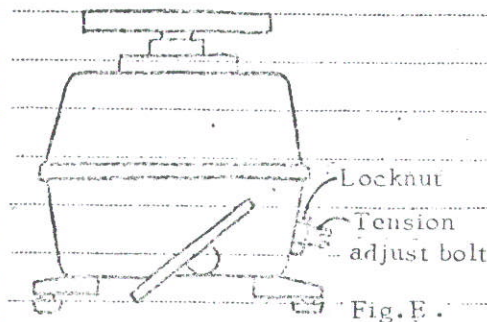

1. Loosen lock-nut.
2. Loosen the tension adjust bolt for 2 turns.
3. Tighten the lock-nut.

2

TO ADJUST B-HOLDER

1. Remove wheelhead.
2. Mark the position of the B-holder.
3. Loosen 4 b-holder fastening bolts.
4. Move the B-holder by 1.5 mm (0.06") to operator's side.
(Measure 1.5mm by the mark of the position, made in procedure 2 above.)
5. Tighten 4 B-holder fixing bolts.
6. Install the wheelhead.

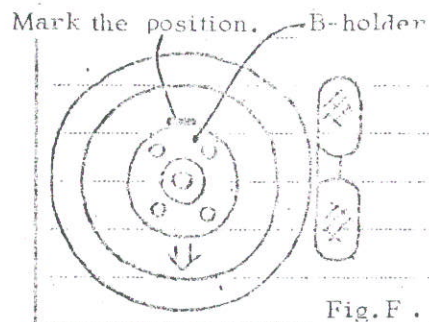

3

TO ADJUST SPEED CONTROL PEDAL/LEVER

Contacting pressure is lowered in 1 and now the speed control pedal/lever should be adjusted for more smooth operation of speed pedal/lever.

1. Remove 4 plus-pan-head screws to free the upper and bottom case.
2. Loosen the lock-nut.
3. Loosen the brake adjust bolt by 1/4 turns.
4. Tighten the lock-nut.
5. Return the lever to the fully stop-position and check the lever itself does not move.
6. If the lever does not move, loosen the brake adjust bolt more 1/4 turns and adjust the moderately smooth lever tightness. Lever must not move by itself at any time.
7. Tighten the brake adjust bolt 1/4 turns for extended use.
8. Place upper case as the speed indicate plate and lever are in the same vertical line..
9. Screw in 4 plus pan-head screws to fasten the cases.

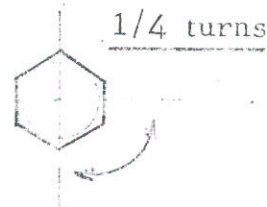
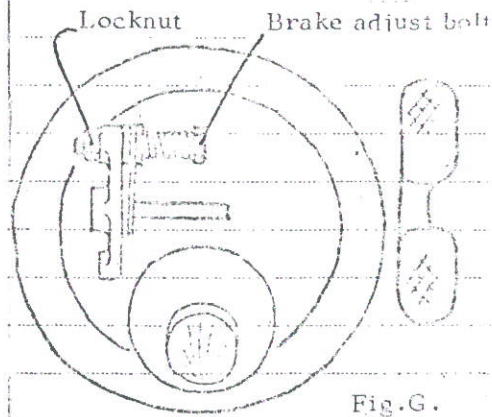

SPEED CONTROL LEVER ADJUSTMENT

The Speed Control Pedal/Lever may become loose with extended use. Please adjust as follows:

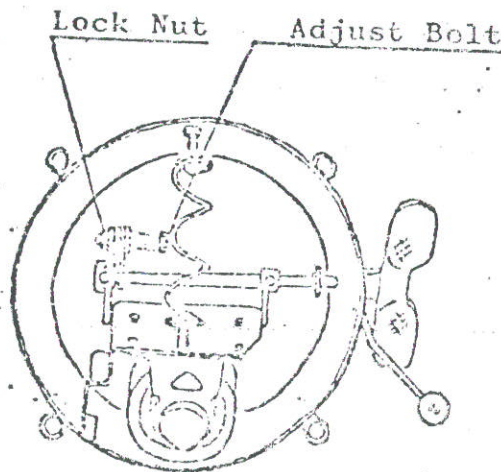

- 1) Open bodycase as shown in fig.
- 2) Loosen lock nut with provided wrench.
- 3) Tighten adjust bolt (turn it 1/4 turns toward clockwise direction). Grasp the tightness of the pedal. Try this until the right adjustment be done.
- 4) Tighten the lock nut.
- 5) Assembly the body case.

Note the speed indicate plate come in the vertical line of the speed control lever (pedal).

TO REPLACE DRIVE RING

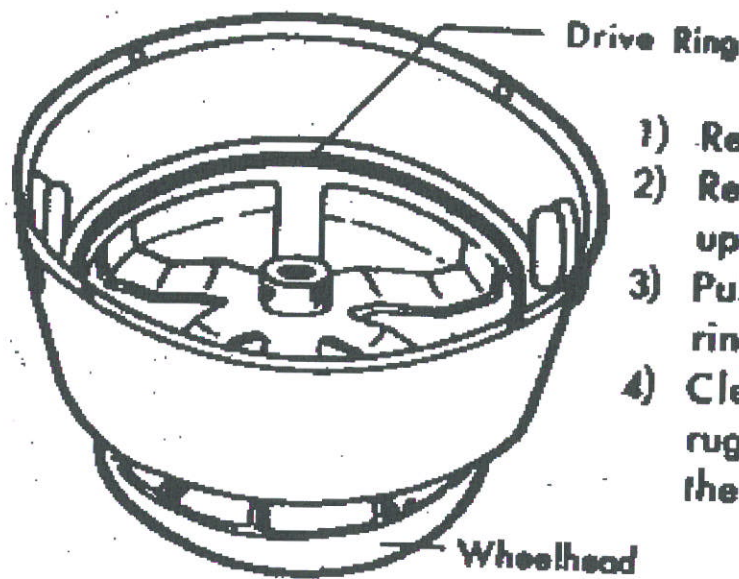

Fig. A

- 1) Remove splash pan.
- 2) Release upper case and place it upside down as fig. A shows.
- 3) Pull it inward to remove drive ring, holding it with plier or drill.
- 4) Clean groove of ring holder with rags. Insert new drive ring into the groove. See fig. A & B.

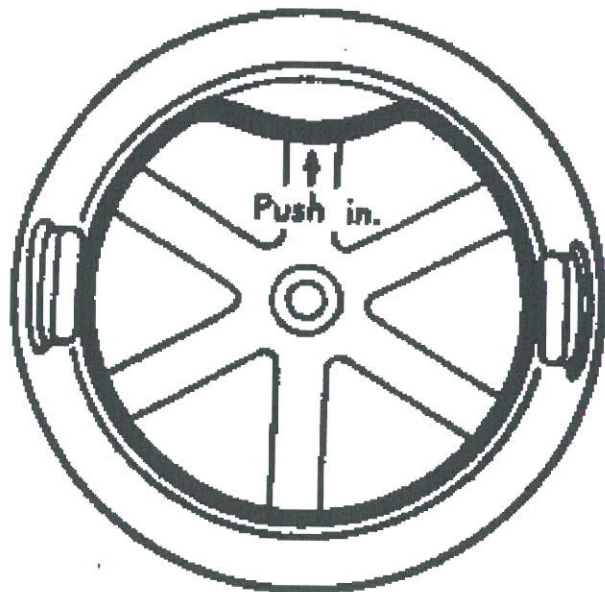

Fig. C

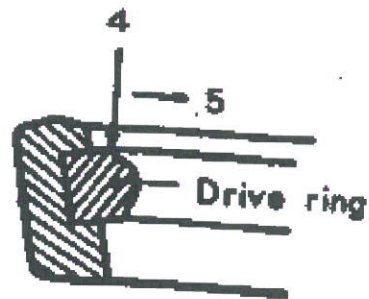



Fig. B

- 5) Push the drive ring into the groove till the last bent is snugly fitted into the groove. See fig. C.

SPECIFICATIONS

- Motor 200W (1/4HP) 115V, 10 Hz, Single phase
- Wheelhead speed Desired voltages are available (Single phase only).
- Direction of wheelhead 50Hz.: 0-200rpm 60Hz.: 0-240rpm
- Dia. of wheelhead Clockwise and counter-clockwise
- Dimensions 12" (300mm)
- Weight 430 x 530 x H490mm
- 66 lbs (30Kgs)

RING & CONE contacting pressure adjustment (AT LOW SPEED)

- 1). Remove wheelhead.
- 2). Measure distance between bearing holder & end of body case, and mark on the measure.
- 3). Loosen 4 fastening bolts by about 2-turns.
- 4). Speed control lever becomes smooth in contacting Ring & Cone. But the torque at LOW SPEED is low, move bearing holder toward AN ARROW  shows by 0.5mm. Fasten 2 bolts and see SMOOTH LEVER CONTROL & TORQUE AT LOW SPEED.
- IF TORQUE is insufficient, repeat the procedures.
- 5). When lever is stiff, move bearing holder toward  ARROW shows.

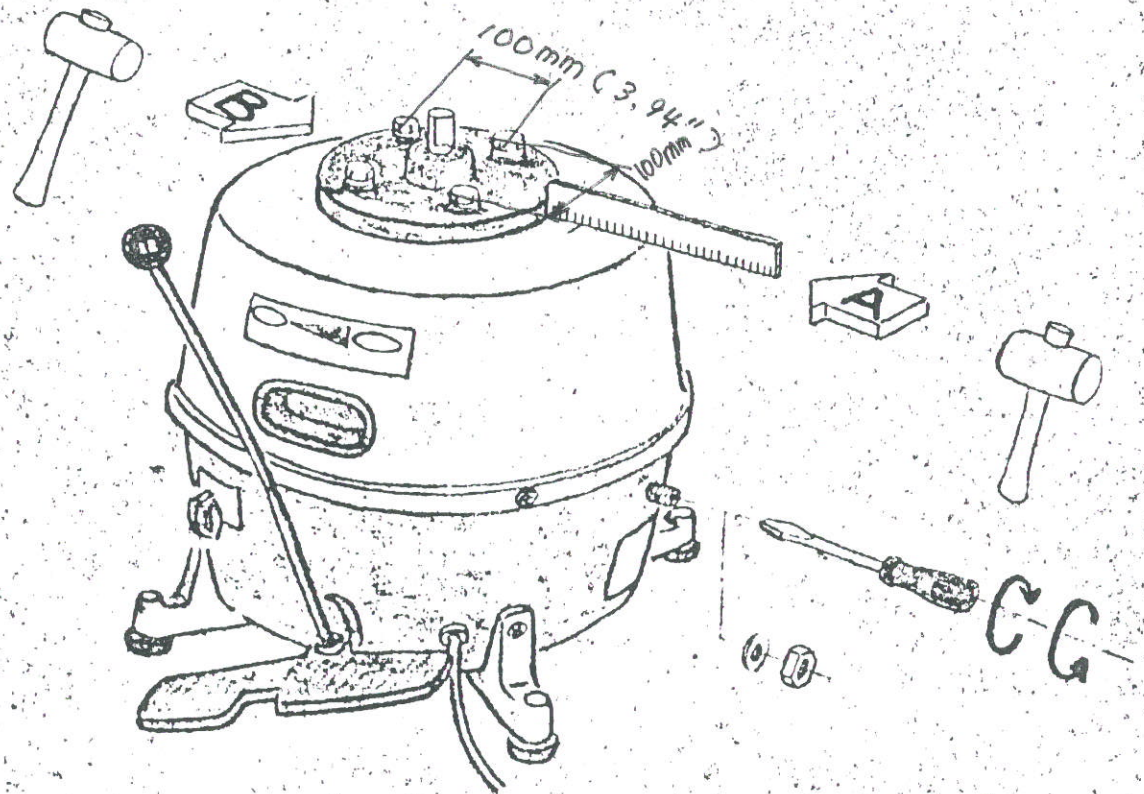

TENSION ADJUSTMENT (AT HIGH SPEED)

- 1) Remove Nut & Washer of Tension Adjust Bolt.
- 2) When torque is low at high speed, turn the tension adjust bolt $\frac{1}{4}$ turns in clockwise direction.
- 3) If torque is insufficient, repeat procedure 2). (Note: Turning the tension bolt should be within 1 turn.)

NOTE: If the tension adjust bolt is screwed in excessively, it will make life of wheel short, and speed control lever will be moved. In this case, tighten adjust bolt, or tighten speed control lever adjust bolt (see inst. manual).

シンボ技標

標

RK-8

分類

設定

作成

題

SERVICE MANUAL

コード

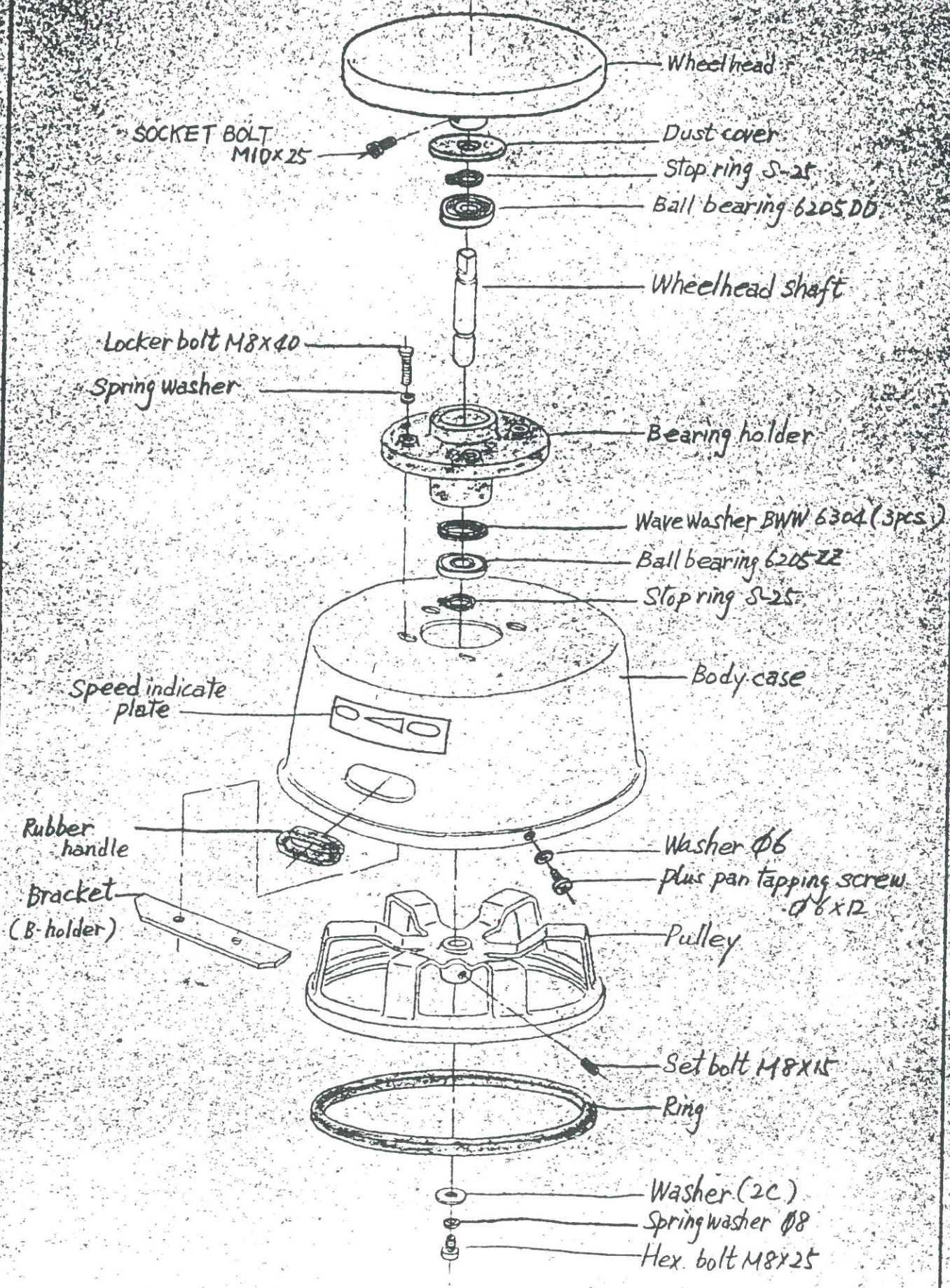

シンポ技標

標
題

RK-8

分類
コード

設定

作成

SERVICE MANUAL

→ Apply 'Anti-seize'
 ○ Apply 'screw-lock'

When setting drive cone on motor shaft,
 ○ make sure set bolt of drive cone matches
 the flat surface of motor shaft.
 ○ Insert cone onto motor shaft to the full end.

When setting motor
 on motor holder, set
shaft of motor and
motor-holder-pin
 come in right angle.
 (Set by eyes.)

When setting motor
 holder onto Arm A&B,
 make sure motor
 holder pin & pedal
 shaft come in a set
 of parallel lines.
 (Confirm by eyes.)

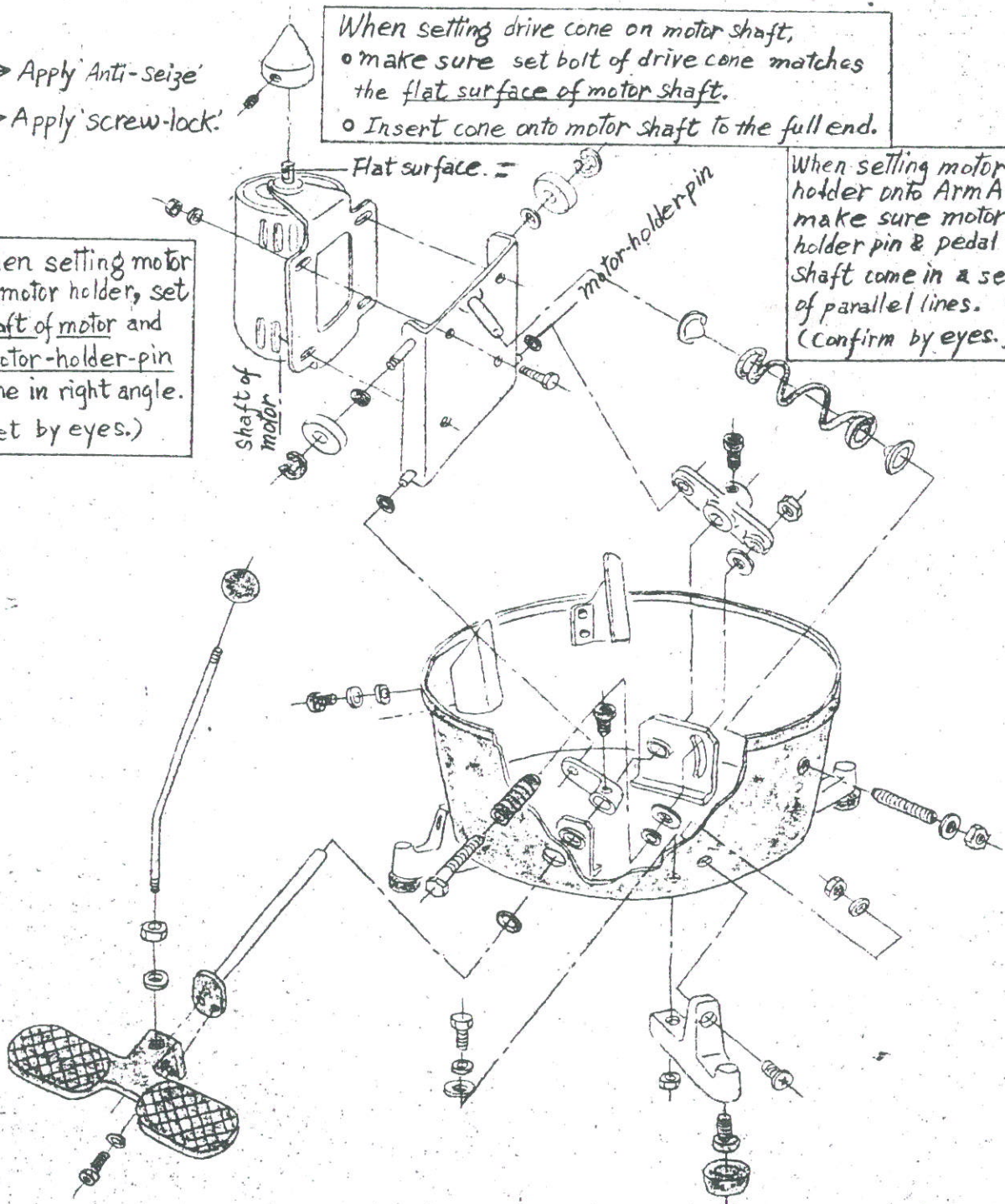

△	△	△		
△	△	△		

シンポ技標		標	RK-8	分類	
設定	作成	題	SERVICE MANUAL	コード	

SHIMPO-WEST POTTERS WHEEL
MODEL RK-8

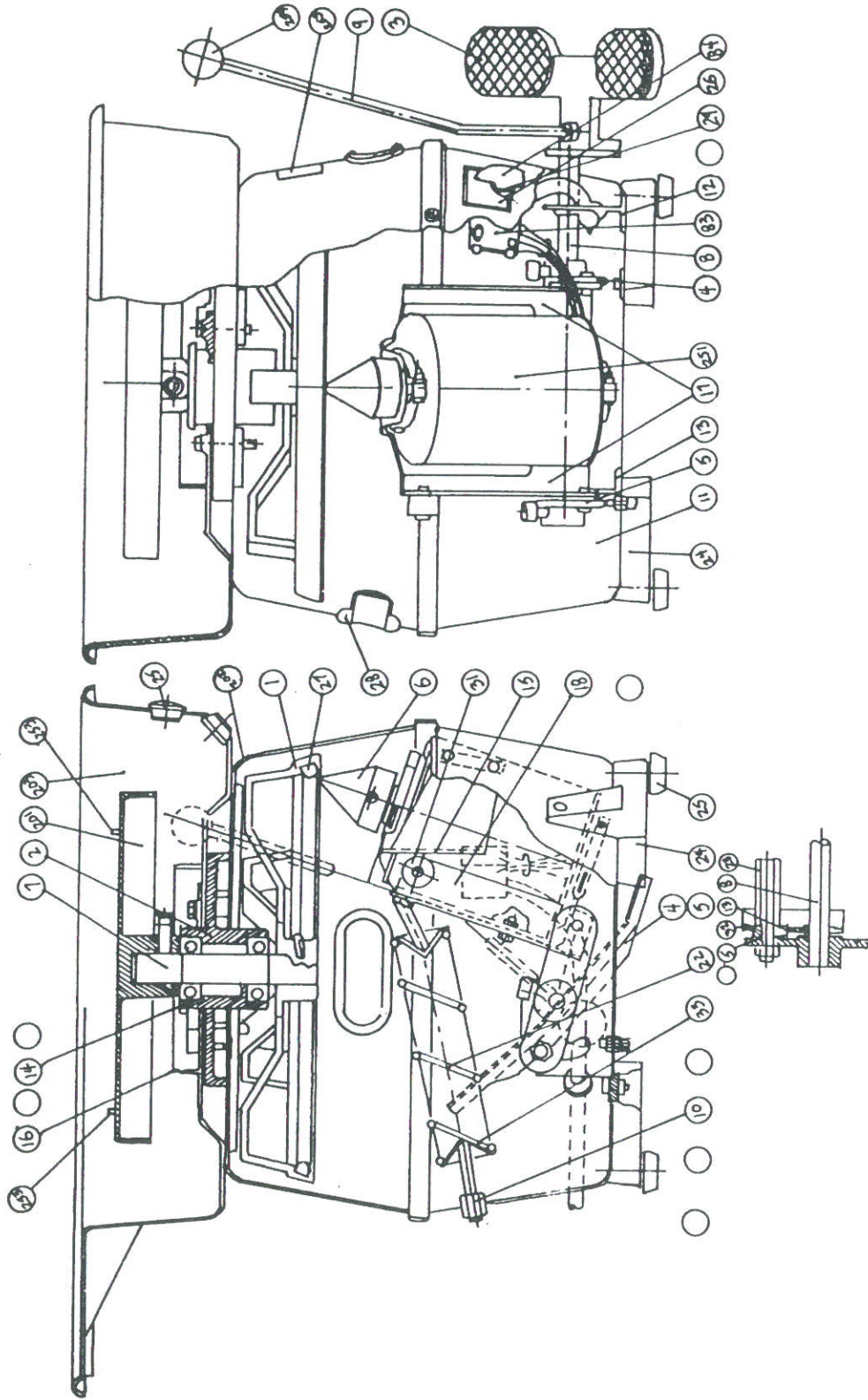

PARTS LIST FOR MODEL RK-8

1. PULLEY
2. BEARING HOLDER
3. SPEED PEDAL
4. ARM-A
5. ARM-B
6. DRIVE CONE
7. WHEELHEAD SHAFT
9. SPEED LEVER
10. ADJUST BOLT
11. CASE B ASSY WITH
12 & 13
14. DUST COVER
15. CAM A
16. SUPPORT PLATE
17. MOTOR HOLDER ASSY
22. SPRING-A
23. SPRING-B
24. LEG
25. RUBBER CAP
26. SWITCH PLATE
27. DRIVE RING
28. RUBBER HANDLE
29. SWITCH BUSH-B
31. ROLLER
32. BRAKE DISC
33. SPRING SHEET
83. CAM SWITCH
84. SWITCH KNOB
201. WHEELHEAD
202. CASE-A
203. SPLASH PAN
251. MOTOR
253. BAT PIN WITH WING NUT
254. GRIP KNOB

OTHERS:

POWER CODE ASSY (V.C.T.)
T WRENCH
SPANNER